

Series 1500/1800

Pressure Balance Shower by Shower Set

FEATURES:

- Forged brass construction
- Valve cartridge 18.30.893
- Diverter cartridge: 18.30.898
- Adjustable hot limit safety stop
- Reversible cartridge
- 4.5 GPM @ 45 PSI
- Certified to meet or exceed the following codes and standards:
ASME A112.18.1/CSAB 125.1-2012

1.007867

(1.007867T - Trim Only)

Sussex Handle

16 pt.

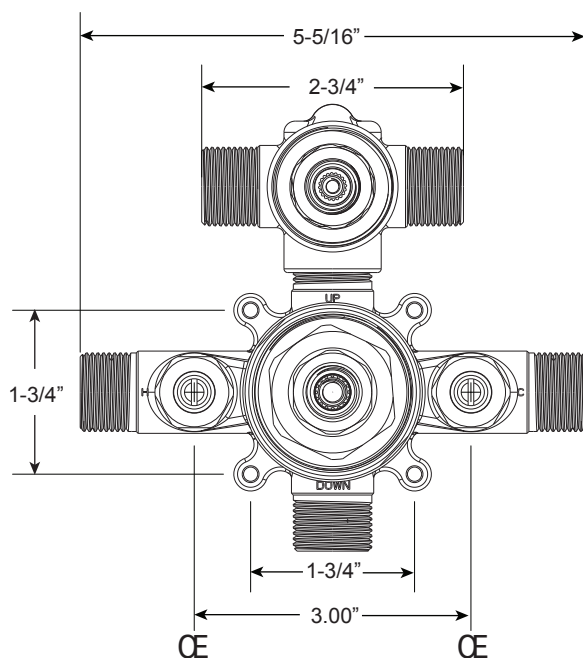

FRONT VIEW

SIDE VIEW

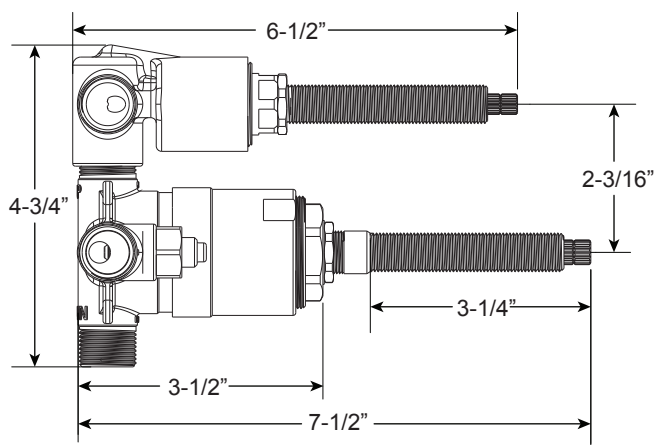

* Current valve in use:
Circa 4/2014 - present
Contact Customer Service
for Older Versions

** For additional information on
cartridges or extension kits,
see 'Rough Valving' section
in current catalog.

**Note: Stem and
all-thread tube will be
sent with handle trim.*

Please Note:

*Must purchase the two desired shower components
separately. See current catalog for shower
component options.*

